

- Use block elastomer.
- Suitable for medium loads, providing shaft to shaft connections.
- Not suitable for backlash-free drive with heavily reversing operation..
- Torsional flexibility, zero maintenance.
- Light mass, small moment of inertia.
- Damp impact and vibration.
- Axial plug-in, fail-safety.
- Good dynamic properties.
- Refer to document No. 04.105 for installation, operation and maintenance instructions.

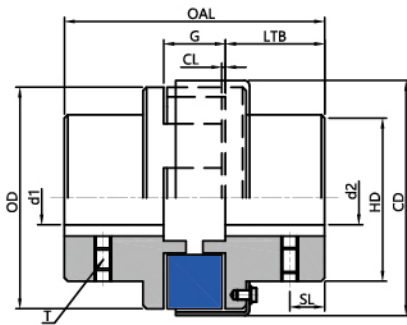
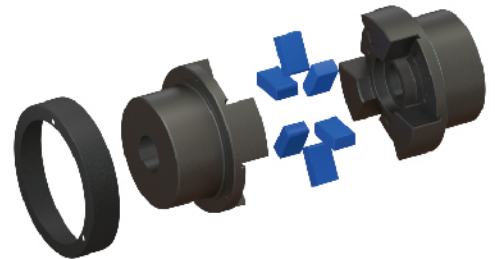

Fig 04.35



Size	Type	Rated Torque Nm		Dimension mm									Screw	
		NBR	Hytrel	d	OAL	LTB	G	CL	OD	HD	CD	SL	T	T _A
-	-	338	671	22-64	177.80	69.85	38.10	3.05	130.81	104.65	139.70	35.05	M12	45
C226	3	533	1066	22-73	199.90	79.25	41.40	3.05	156.97	127.00	165.86	39.62	M12	45
C276	3	854	1567	32-76	199.90	79.25	41.40	3.05	190.50	139.70	198.37	39.62	M16	90
C280	3	1038	1882	32-102	231.90	95.25	41.40	3.05	215.90	165.10	225.55	44.45	M16	90
C285	3	1281	2563	38-89	238.25	95.25	47.75	3.05	231.65	158.75	244.35	47.75	M16	90
C295	3	2136	4271	44-102	263.65	107.95	47.75	3.05	231.65	180.85	244.35	53.85	M16	90

- D is the bore diameter, the metric cylindrical bore executes GB3852-2107 standard, tolerance H7, flat keyway, also executes GB/T1095-2003 standard, tolerance JS9. The inch bore implements the AGMA9002-C14 standard, the bore is a clearance fit, and the keyway is a commercial grade.
- Hexagon socket set screw with cup point, comply with, GB/T80-2007, hardness level 45H. TA indicates the tightening torque (unit: Nm).